

TO.ME.S. OIL

SINCE 1977 Made in Italy ISO 9001:2008



Elettropompe a palette autoadescanti con motore asincrono a corrente alternata. Corpo pompa costruito con materiali di qualità, leggeri, con acciaio all'interno, albero guidato e motore a bassi giri garantiscono prestazioni durature nel tempo. Equipaggiata con l'esclusivo sistema TO.ME.S. di ottimizzazione del trasferimento dei fluidi che aumenta l'efficienza e le prestazioni, diminuendo i decibel.

Self-priming vanes Electric pumps, powered by asynchronous AC motor. High quality light materials Pump body construction, iron inside, shaft guided and at low engine rpm ensure long-lasting performance. Equipped with TO.ME.S. exclusive fluid transfer optimization system which increases efficiency and performance while reduces decibels.



Fast Trasfer

2800 RPM

Long Life

1400 RPM

ALUMINIUM



IRON INSIDE

BY-PASS ADJUSTABLE



ANTI-FLOODING



FREE MAX  
60  
LT/MIN

THERMAL  
PROTECTOR  
AUTO-RESET

UP TO  
500  
cSt

DIMENSION  
(mm)

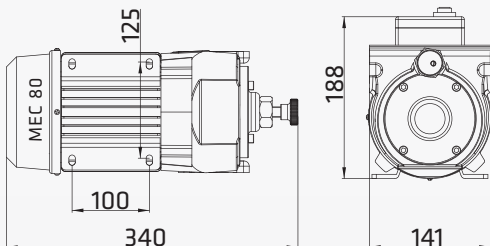

SUCTION

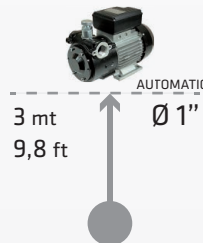

PERFORMANCE

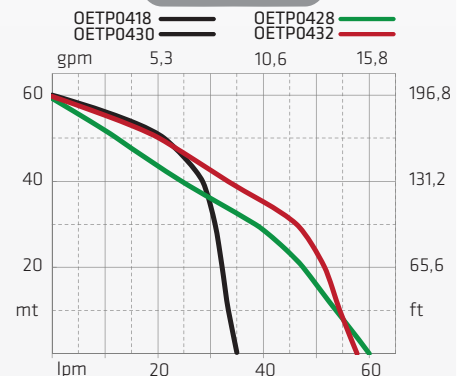

name	flow rate		bar	volts	hp   watt		ampere max	RPM	IN	OUT	weight		packing		code
	LPM	GPM			kg	lbs					cm	inch			
A-OIL	32	8,7	6	230 50Hz	1,2	895	7	1400	1" F BSP	1" F BSP	16,5	36,2	18 x 34 x 26	7,1 x 13,4 x 10,2	OETP0418
	33	8,5	6	400 50Hz	1	746	2,5	1400	1" F BSP	1" F BSP	13,8	30,4	18 x 34 x 26	7,1 x 13,4 x 10,2	OETP0430
	55	14,5	6	230 50Hz	2	1491	8	2800	1" F BSP	1" F BSP	17,3	38,1	18 x 34 x 26	7,1 x 13,4 x 10,2	OETP0428
	54	14,3	6	400 50Hz	1,5	1119	3	2800	1" F BSP	1" F BSP	15,5	34,8	18 x 34 x 26	7,1 x 13,4 x 10,2	OETP0432

TO.ME.S. OIL

SINCE 1977 Made in Italy ISO 9001:2008



Elettropompe a palette autoadescanti con motore asincrono a corrente alternata. Corpo pompa in ghisa verniciata, albero guidato e motore a bassi regimi garantiscono prestazioni durature nel tempo. Equipaggiata con l'esclusivo sistema TO.ME.S. di ottimizzazione del trasferimento dei fluidi che aumenta l'efficienza e le prestazioni, diminuendo i decibel.

Self-priming vanes Electric pumps, powered by asynchronous AC motor. Painted cast iron Body. Shaft guided and low engine rpm ensure long-lasting performance. Equipped with TO.ME.S. exclusive fluid transfer optimization system which increases efficiency and performance while reduces decibels.

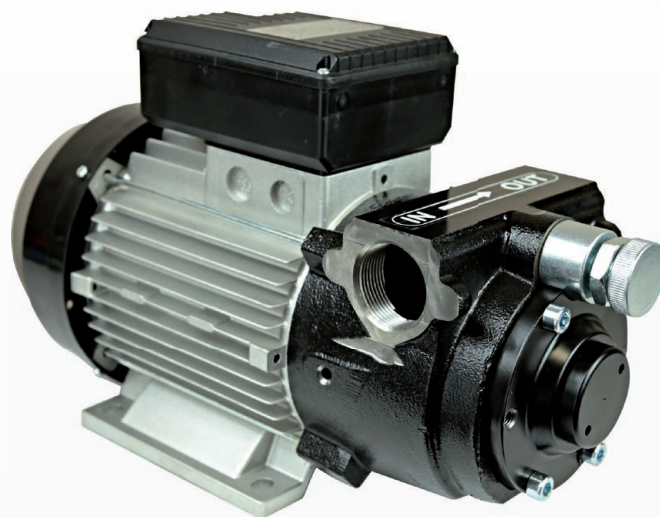

### CAST IRON



### BY-PASS ADJUSTABLE



### ANTI-FLOODING



FREE MAX  
**90**  
LT/MIN

THERMAL  
PROTECTOR  
AUTO-RESET



1 bar pres.  
**88**  
LT/MIN

UP TO  
**500**  
hSt

### DIMENSION (mm)

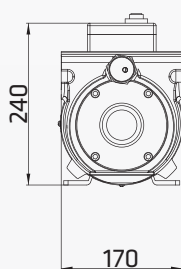
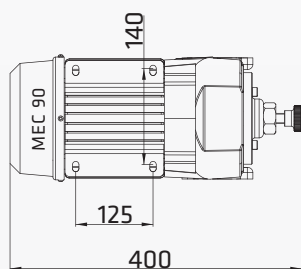

### SUCTION

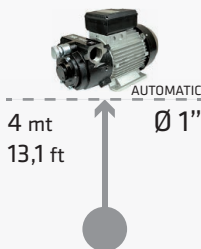

### PERFORMANCE

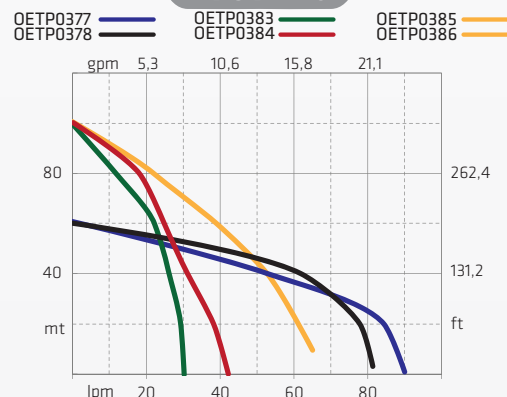

name	flow rate		bar	volts	hp   watt		ampere max	RPM	IN	OUT	weight		packing		code
	LPM	GPM			kg	lbs					cm	inch			
V-OIL	30	7,9	10	230 50Hz	2	1491	9	1400	1 1/4" F BSP	1 1/4" F BSP	27	59,5	46 x 26 x 37	18,1x10,2x14,2	OETP0383
	41	10,8	10	400 50Hz	1,5	1118	2,6	1400	1 1/4" F BSP	1 1/4" F BSP	23	50,7	46 x 26 x 37	18,1x10,2x14,2	OETP0384
	66	17,4	10	230 50Hz	2,5	1864	9,5	1400	1 1/4" F BSP	1 1/4" F BSP	27	59,5	46 x 26 x 37	18,1x10,2x14,2	OETP0385
	63	16,6	10	400 50Hz	1,5	1118	3,7	1400	1 1/4" F BSP	1 1/4" F BSP	22,5	49,6	46 x 26 x 37	18,1x10,2x14,2	OETP0386
	88	23,2	6	230 50Hz	2,5	1864	9	1400	1 1/4" F BSP	1 1/4" F BSP	28	61,7	46 x 26 x 37	18,1x10,2x14,2	OETP0377
	79	20,9	6	400 50Hz	2	1491	3,8	1400	1 1/4" F BSP	1 1/4" F BSP	25	55,1	46 x 26 x 37	18,1x10,2x14,2	OETP0378

# AVVOLGITUBO AUTOMATICO

SMALL

# AUTOMATIC HOSE REELS

TO.ME.S. OIL  
SINCE 1977 Made in Italy ISO 9001:2008



Avvolgitubo automatico per olio resistente alle intemperie. Solido, compatto, con perdite di carico ridotte al minimo. Possibilità di arresto svolgimento del tubo ad ogni giro.



Oil Automatic Hose Reel, weatherproof. Solid, compact, minimum pressure loss. Hose-Stop at any turn possible.



OAVT0803

PAINTED STEEL



MULTI POSITION

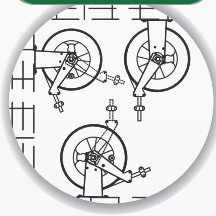

UP TO  
10  
mt

HOSE  
R1AT  
160 bar

AUTOMATIC  
RETURN  
HOSE

DEVICE  
HOSE  
GUIDE

DEVICE  
HOSE  
BUMPER

DEVICE  
HOSE  
STOP

DIMENSION  
(mm)

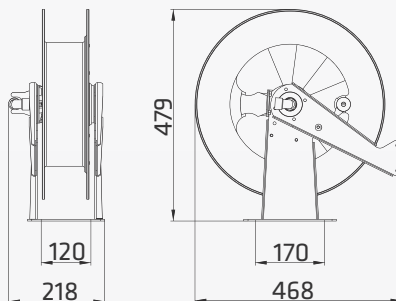

REVOLVING BRACKET

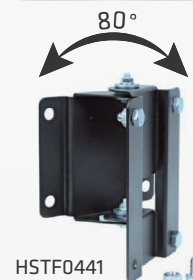

HSTF0441

name	hose including		hose max		bar max	IN	OUT	weight		packing		code	
	mt	ft	mt	ft				kg	lbs	cm	inch		
SMALL	NO		3/8"	10	32,8	80	1/2" F BSP	3/8" M BSP	12,0	26,5	46 x 46 x 27	18,1 x 18,1 x 10,6	OAVT0800
	3/8"	10	32,8			80	1/2" F BSP	3/8" M BSP	15,2	33,5	46 x 46 x 27	18,1 x 18,1 x 10,6	OAVT0803

TO.ME.S. OIL  
 SINCE 1977 Made in Italy ISO 9001:2008



Avvolgitubo automatico per olio resistente alle intemperie.  
 Solido, compatto, con perdite di carico ridotte al minimo.  
 Possibilità di arresto svolgimento del tubo ad ogni giro.



Oil Automatic Hose Reel, weatherproof.  
 Solid, compact, minimum pressure loss.  
 Hose-Stop at any turn possible.



OAVT0382  
OAVT0383

POLYPROPYLENE



PAINTED STEEL

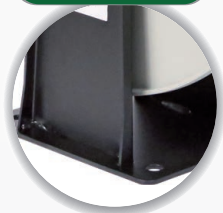

MULTI POSITION

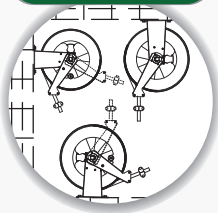

UP TO  
15  
mt

HOSE  
R1AT  
160 bar

AUTOMATIC  
RETURN  
HOSE

DEVICE  
HOSE  
GUIDE

DEVICE  
HOSE  
BUMPER

DEVICE  
HOSE  
STOP

DIMENSION  
(mm)

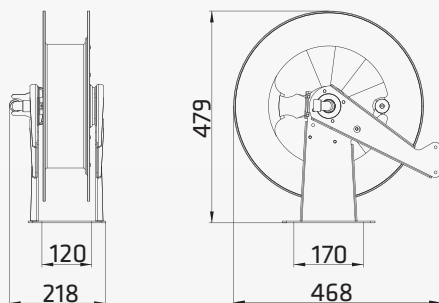

REVOLVING BRACKET

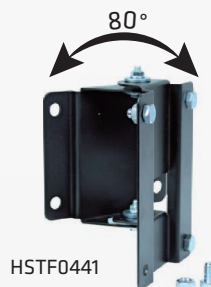

HSTF0441

name	hose including	mt		ft		hose max	bar	IN	OUT	weight		packing		code
										kg	lbs	cm	inch	
MEDIUM A	NO			1/2"	15	49,2	80	1/2" F BSP	1/2" M BSP	19	41,9	46 x 55 x 24	18,1 x 21,7 x 9,4	OAVT0381
	1/2"	10	32,8				80	1/2" F BSP	1/2" M BSP	23	50,7	46 x 55 x 24	18,1 x 27,7 x 9,4	OAVT0382
	1/2"	15	49,2				80	1/2" F BSP	1/2" M BSP	24	52,9	46 x 55 x 24	18,1 x 21,7 x 9,4	OAVT0383

TO.ME.S. OIL  
 SINCE 1977 Made in Italy ISO 9001:2008



Avvolgitubo automatico per olio resistente alle intemperie. Solido, compatto, con perdite di carico ridotte al minimo. Possibilità di arresto svolgimento del tubo ad ogni giro.



Oil Automatic Hose Reel, weatherproof. Solid, compact, minimum pressure loss. Hose-Stop at any turn possible.



OAVT0379  
OAVT0380

REVOLVING BRACKET



POLYPROPYLENE

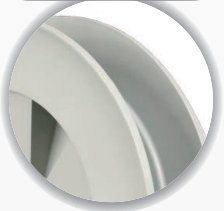

PAINTED STEEL



MULTI POSITION

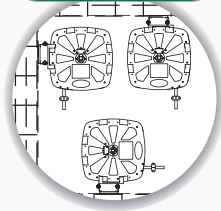

UP TO  
15  
mt

HOSE  
R1AT  
160 bar



AUTOMATIC  
RETURN  
HOSE

DEVICE  
HOSE  
GUIDE

DEVICE  
HOSE  
BUMPER

DEVICE  
HOSE  
STOP

DIMENSION  
(mm)

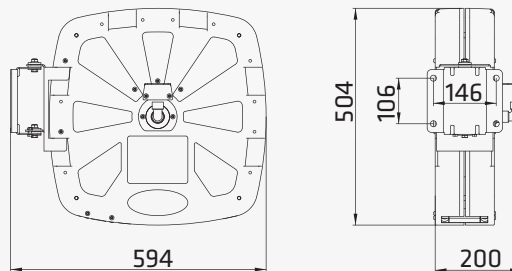

name	hose including	mt   ft		hose max	mt   ft		bar	IN	OUT	weight		packing		code
		mt	ft		mt	ft				kg	lbs	cm	inch	
MEDIUM C	NO			1/2"	15	49,2	80	1/2" F BSP	1/2" M BSP	20,5	45,2	54 x 61 x 24	21,3 x 24 x 9,4	OAVT0378
	1/2"	10	32,8				80	1/2" F BSP	1/2" M BSP	24,5	54	54 x 61 x 24	21,3 x 24 x 9,4	OAVT0379
	1/2"	15	49,2				80	1/2" F BSP	1/2" M BSP	25,5	56,2	54 x 61 x 24	21,3 x 24 x 9,4	OAVT0380

TO.ME.S. OIL

SINCE 1977 Made in Italy ISO 9001:2008



Avvolgitubo automatico per olio resistente alle intemperie. Solido, compatto, con perdite di carico ridotte al minimo. Possibilità di arresto svolgimento del tubo ad ogni giro.



Oil Automatic Hose Reel, weatherproof. Solid, compact, minimum pressure loss. Hose-Stop at any turn possible.



OAVT0669

**PAINTED STEEL**



**MULTI POSITION**

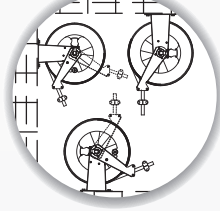

UP TO  
**20**  
mt

HOSE  
RIAT  
**160 bar**

AUTOMATIC  
RETURN  
HOSE

DEVICE  
HOSE  
GUIDE

DEVICE  
HOSE  
BUMPER

DEVICE  
HOSE  
STOP

**DIMENSION**  
(mm)

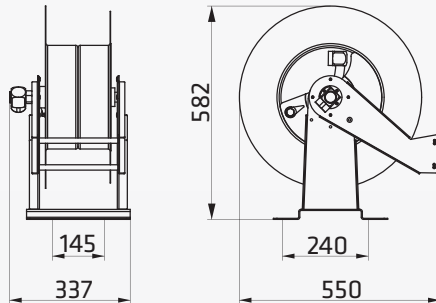

**REVOLVING BRACKET**



HSTF0443

name	hose including	mt   ft		hose max		bar	IN	OUT	weight		packing		code
		mt	ft	mt	ft				kg	lbs	cm	inch	
LARGE B	NO			3/4"	15   49,2	80	3/4" F BSP	3/4" M BSP	25	55,1	61 x 35 x 65	24 x 13,8 x 25,6	OAVT0667
				1/2"	20   65,6	80	3/4" F BSP	3/4" M BSP	25	55,1	61 x 35 x 65	24 x 13,8 x 25,6	
	3/4"	15	49,2			80	3/4" F BSP	3/4" M BSP	37	81,6	61 x 35 x 65	24 x 13,8 x 25,6	OAVT0669
	1/2"	20	65,6			80	3/4" F BSP	3/4" M BSP	34	75	61 x 35 x 65	24 x 13,8 x 25,6	OAVT0673

TO.ME.S. OIL

SINCE 1977 Made in Italy ISO 9001:2008



Contaltri per il controllo dell'erogazione e della distribuzione privata di olio. Leggero, compatto, equipaggiato di una elettronica semplice con funzione di autotaratura. Non è idoneo per travasi a gravità.



Flow meter for controlling the dispensing and distribution of private oil. Lightweight, compact, equipped with a simple electronic with function of auto-tuning. It is not suitable for decanting gravity.



COVER PROTECTION

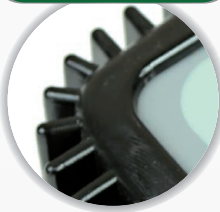

LCD



ALUMINIUM



UP TO 30 LT/MIN

DUAL GEAR

BATCH PARTIAL TOTAL

INLET ADJUSTABLE

FUNCTION AUTO CALIBRATION

1 BATTERY

DIMENSION (mm)

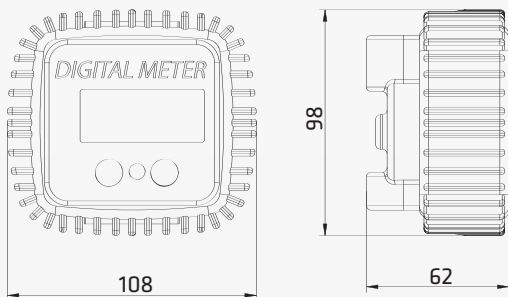

PERFORMANCE

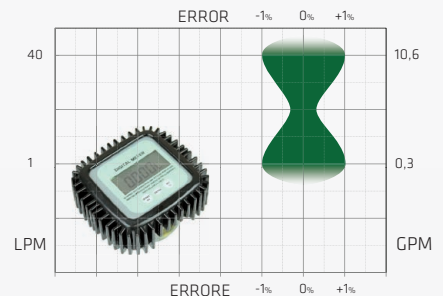

name	flow rate		battery	precision +/- %	ripetibility %	BAR max	IN	OUT	weight		packing		code
	LPM	GPM							kg	lbs	cm	inch	
DMA	1 - 30	0,3 - 7,9	AA 3,6V	1	0,5	10	1/2" F BSP	1/2" F BSP	0,6	1,3	12 x 11 x 8	4,7 x 4,3 x 3,1	OCTL0019
	1 - 30	0,3 - 7,9	AA 3,6V	1	0,5	10	1/2" F BSP	1/2" F BSP	0,6	1,3	12 x 11 x 8	4,7 x 4,3 x 3,1	OCTL0020 *
	1 - 30	0,3 - 7,9	AA 3,6V	1	0,5	10	3/4" F BSP	3/4" F BSP	0,6	1,3	12 x 11 x 8	4,7 x 4,3 x 3,1	OCTL0021
	1 - 30	0,3 - 7,9	AA 3,6V	1	0,5	10	3/4" F BSP	3/4" F BSP	0,6	1,3	12 x 11 x 8	4,7 x 4,3 x 3,1	OCTL0022 *

\* NO COVER

TO.ME.S. OIL

SINCE 1977 Made in Italy ISO 9001:2008



Pistola manuale per l'erogazione di olio con apertura graduale della leva, completa di girevole e filtro impurità incorporato. Beccuccio speciale per un getto ben direzionato in uscita.

Hand nozzle for dispensing oil, progressive opening of the lever, complete with swivel and filter impurities incorporated. Special spout for a jet well directed output.

ALSO FOR EXHAUSTED OIL



OPST0037



OPST0029

SWIVEL



FILTER INCLUDED

HOOK



LOCK



METER



Included in OPST0037

WITHOUT DRIP VALVE



OBEC0130

GOOD FOR PNEUMATIC PUMPS

SPOUT A

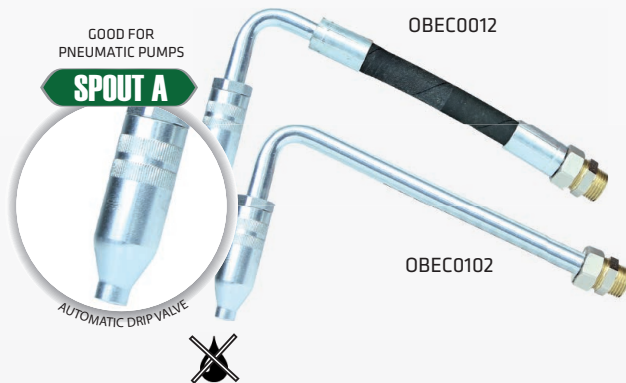

OBEC0012

OBEC0102

AUTOMATIC DRIP VALVE



name	flow rate		swivel	flow meter	drip valve		spout ext. Ø	bar max	IN	weight		packing		code
	LPM	GPM			auto	manual				kg	lbs	cm	inch	
NOZZLE	30	7,9	X					100	1/2" F BSP	0,55	1,2	20 x 11 x 4	7,9 x 4,3 x 1,6	OPST0029
	30	7,9	X	X				100	1/2" F BSP	1,18	2,6	20 x 11 x 11	7,9 x 4,3 x 4,3	OPST0037
SPOUT					X		13 mm		1/2" M BSP	0,45	1			OBEC0012
					X		13 mm		1/2" M BSP	0,35	0,8			OBEC0102
							14 mm		1/2" M BSP	0,17	0,4			OBEC0130
NOZZLE + SPOUT			X			any			1/2" M BSP	1	2,2	48 x 11 x 4	9,4 x 4,3 x 1,6	
			X	X		any			1/2" M BSP	1,6	3,5	58 x 11 x 11	13,4 x 4,3 x 4,3	



TO.ME.S. OIL  
 SINCE 1977 Made in Italy ISO 9001:2008



Pistola manuale per l'erogazione di olio ad alta portata con apertura graduale della leva, completa di girevole e filtro impurità incorporato.  
 Beccuccio speciale per un getto ben direzionato in uscita.

Hand nozzle for high flow dispensing oil, progressive opening of the lever, complete with swivel and filter impurities incorporated.  
 Special spout for a jet well directed output.



OPST0129



OPST0123

SWIVEL



FILTER INCLUDED

HOOK



LOCK



METER



Included in OPST0123

SPOUT M



OBEC0170

OBEC0093

MANUAL DRIP VALVE



SPOUT A

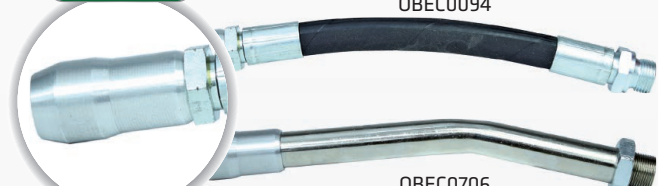

OBEC0094

OBEC0706

AUTOMATIC DRIP VALVE



OBEC0035

WITHOUT DRIP VALVE



OBEC0036

name	flow rate		swivel	flow meter	drip valve		spout ext. Ø	bar max	IN	weight		packing		code
	LPM	GPM			auto	manual				kg	lbs	cm	inch	
NOZZLE	50	13,2	X					70	1" F BSP	1,4	3,1	24 x 20 x 5	9,4 x 7,9 x 2	OPST0123
	30	7,9	X	X				30	1" F BSP	2	4,4	34 x 20 x 11	13,4 x 7,9 x 4,3	OPST0129
SPOUT							25 mm		M 22x1,5	0,35	0,8			OBEC0035
							25 mm		M 22x1,5	0,36	0,8			OBEC0036
						X	24 mm		M 22x1,5	0,46	1			OBEC0093
					X		30 mm		M 22x1,5	0,4	0,9			OBEC0094
						X	24 mm		M 22x1,5	0,47	1			OBEC0170
					X	30 mm		M 22x1,5	0,38	0,8				OBEC0706
NOZZLE + SPOUT			X			any			1" F BSP	2,4	5,3	48 x 20 x 5	9,4 x 7,9 x 2	
			X	X		any			1" F BSP	3	6,6	58 x 20 x 11	13,4 x 7,9 x 4,3	

TO.ME.S. OIL

SINCE 1977 Made in Italy ISO 9001:2008



Pompe manuali per il travaso e l'erogazione dell'olio. Costruite con materiali di pregio, sfruttano sistemi collaudati che ne garantiscono sempre il funzionamento e la durata.

Hand pumps for the transfer and dispensing oil. Built with high quality materials, utilize tested systems that guarantee always the functioning and lifetime.



name	flow rate to stroke		made in	viscosity oil	suction	valve suction	drum	length hose mt	spout ext. Ømm	weight		packing		code
	GR	LBS								kg	lbs	cm	inch	
MA2	300	0,66	cast iron	medium	rigid	yes	all drum	-	22	5,7	12,6	19 x 14 x 115	7,5 x 5,5 x 45,3	DPMA0082
MA14	250	0,55	aluminium	medium	telescopic	yes	all drum	-	-	2,2	4,9	14 x 6,5 x 47	5,5 x 2,6 x 18,5	OPMA0096
MA double acting	480	1,06	steel	all type	telescopic	yes	all drum	1,8	13	4	8,8	10 x 25 x 71	3,9 x 9,8 x 28,0	OPMA0264
MA1/A	210	0,46	aluminium	medium	telescopic	yes	all drum	1	18	1,7	3,7	14 x 14 x 47	5,5 x 5,5 x 18,5	DPMA0550

TO.ME.S. OIL  
 SINCE 1977 Made in Italy ISO 9001:2008



Tubo in gomma sintetica rinforzata, idoneo per l'uso in bobina degli avvolgitubo.

Rubber hose reinforced synthetic, suitable for use in reel of the hose reel.



OTUB0638  
 OTUB0639  
 OTUB0776  
 OTUB0641  
 OTUB0642



OTUB0016



RHSP0010



RHSP0013



for hose reel  
 SMALL  
 MEDIUM A

HSTF0441



for hose reel  
 LARGE

HSTF0443



ORIENTABLE 80°



PAINTED STEEL



ORIENTABLE 80°



PAINTED STEEL

name	hose	length mt	made in	W.P.	connection		code
HOSE for hose reel	3/8"	10	synthetic rubber	160 bar	3/8" M BSP	3/8" F BSP 90°	OTUB0016
	1/2"	10	synthetic rubber	160 bar	1/2" M BSP	1/2" F BSP	OTUB0638
	1/2"	15	synthetic rubber	160 bar	1/2" M BSP	1/2" F BSP	OTUB0639
	1/2"	20	synthetic rubber	160 bar	1/2" M BSP	1/2" F BSP	OTUB0776
	3/4"	15	synthetic rubber	105 bar	3/4" M BSP	3/4" F BSP	OTUB0642
HOSE STOP					1/4" - 3/8" - 1/2"		RHSP0010
					3/4"		RHSP0013
REVOLVING BRACKET							HSTF0443
							HSTF0441